

PAUL R. LAZARUS &
LAURA RIPP LAZARUS
L. 687 P. 69
TM*181.00-3-812

GERALD S. MORROW & CAROL L. WOOD
INSTR. *2012-005038
TM*181.00-3-6140

PAUL R. & LAURA R. LAZARUS
INSTR. *2013-008419
TM*198.00-2-1140

RICHARD L. & SANDRA J. TERRY
INSTR. *2018-004814
TM*198.00-2-1152

REPLACEMENT OF KOTEL ROAD CULVERT
OVER SOUTH BRANCH CRYSTAL CREEK
TOWN OF WATSON, LEWIS COUNTY
PIN 7754.24

- LEGEND:**
- PROPOSED ROADWAY MILLING & RESURFACING
 - PROPOSED CULVERT RECONSTRUCTION
 - PROPOSED ROADWAY AND SHOULDER FULL DEPTH RECONSTRUCTION
 - EARTHWORK LIMIT
 - WATER

TOWN OF WATSON



LEWIS COUNTY
HIGHWAY DEPARTMENT



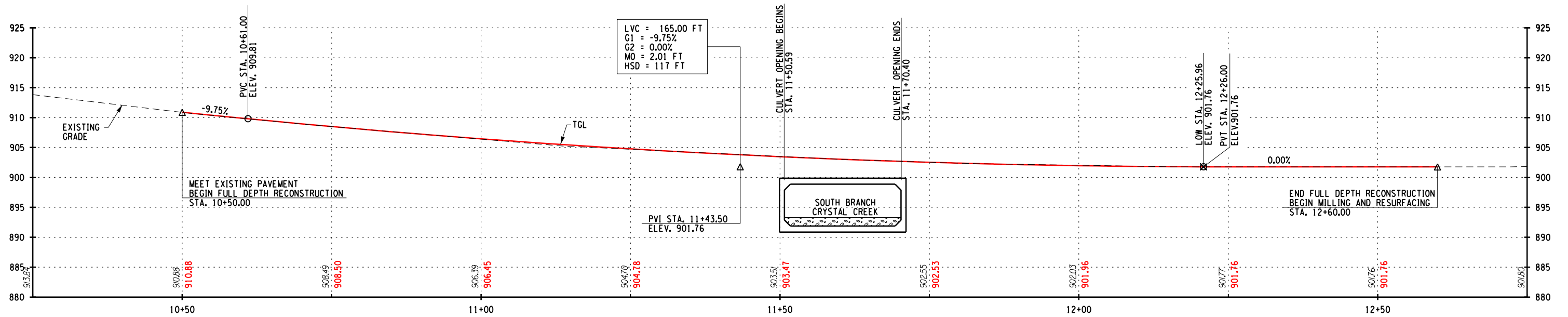

KOTEL ROAD PROFILE

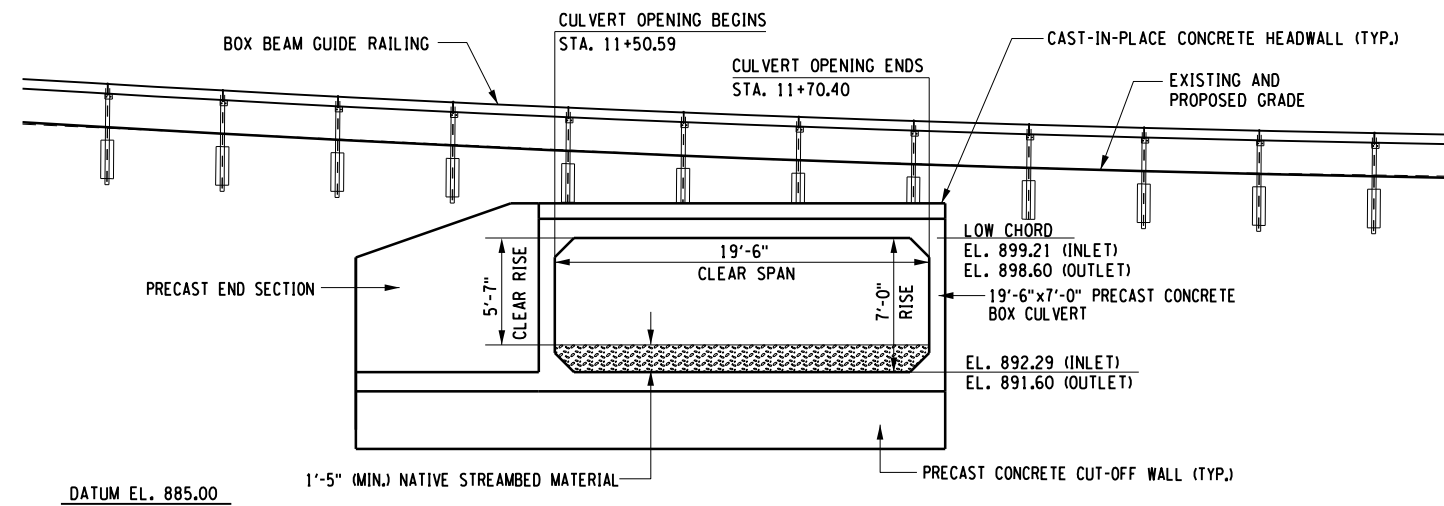

CULVERT ELEVATION

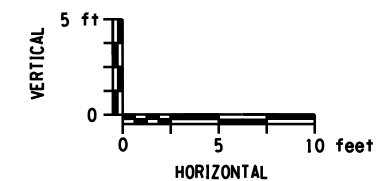

REPLACEMENT OF KOTEL ROAD CULVERT
OVER SOUTH BRANCH CRYSTAL CREEK
TOWN OF WATSON, LEWIS COUNTY
PIN 7754.24

TOWN OF WATSON



LEWIS COUNTY
HIGHWAY DEPARTMENT



Department of
Transportation

Barton
& Loguidice

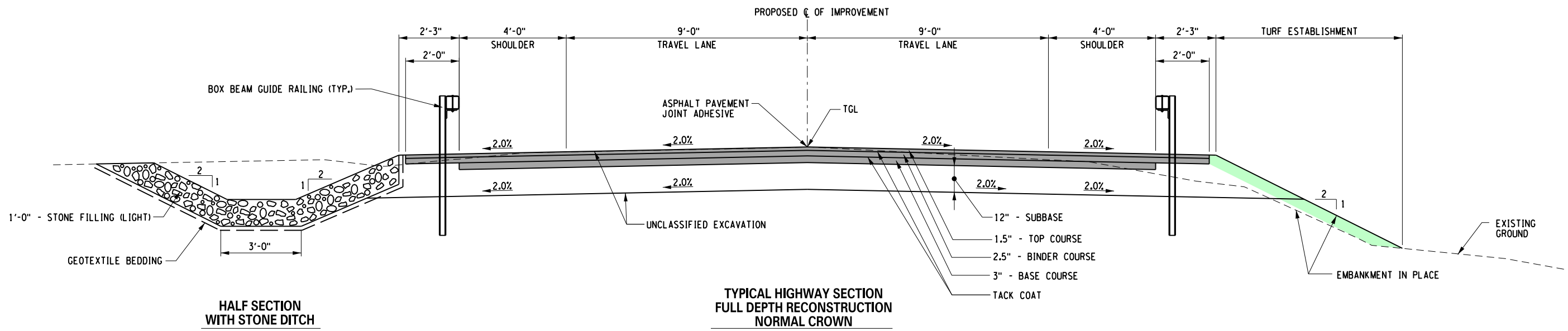
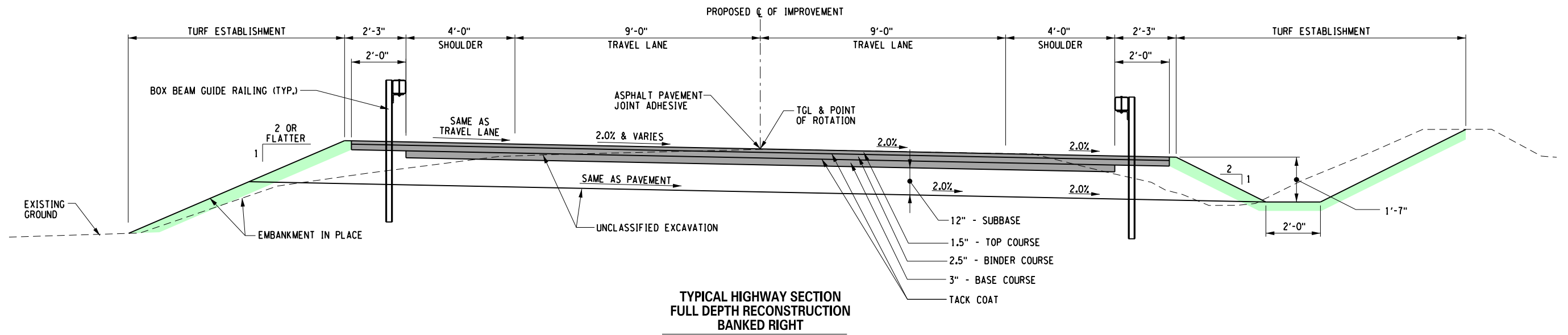

**HALF SECTION
WITH STONE DITCH**

**REPLACEMENT OF KOTEL ROAD CULVERT
OVER SOUTH BRANCH CRYSTAL CREEK
TOWN OF WATSON, LEWIS COUNTY
PIN 7754.24**

LEGEND:

- PROPOSED ROADWAY AND SHOULDER FULL DEPTH RECONSTRUCTION
- EARTHWORK LIMIT

TOWN OF WATSON



LEWIS COUNTY
HIGHWAY DEPARTMENT



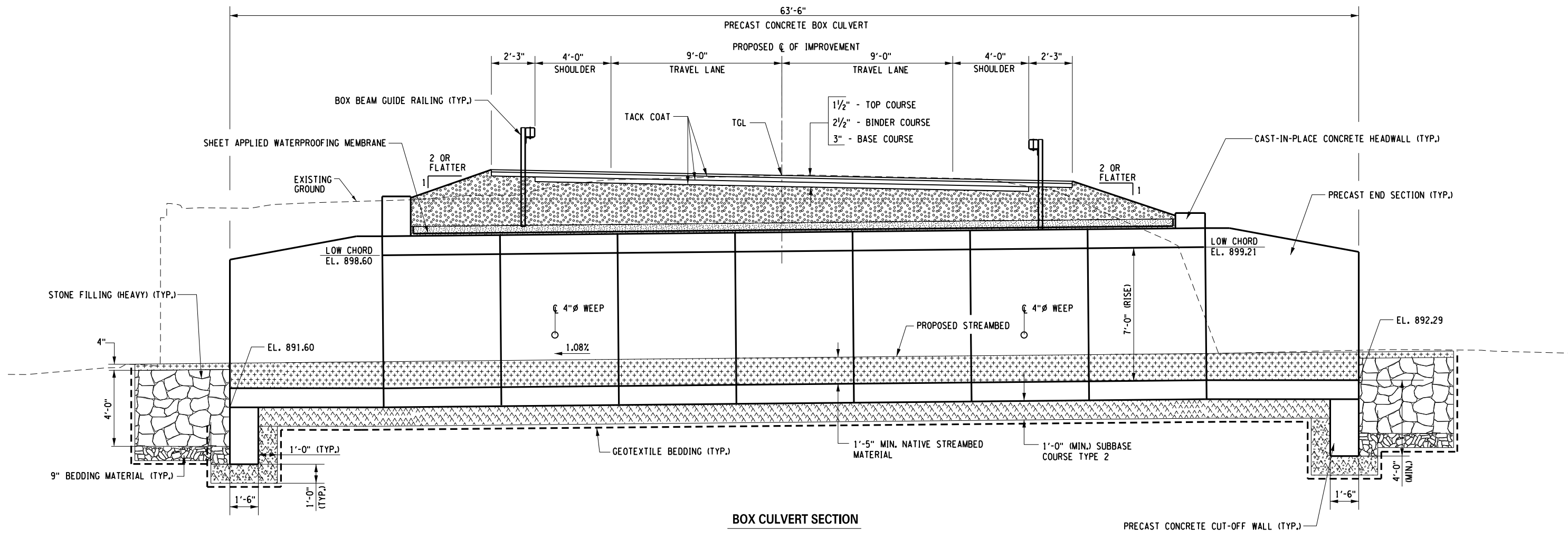

REPLACEMENT OF KOTEL ROAD CULVERT
 OVER SOUTH BRANCH CRYSTAL CREEK
 TOWN OF WATSON, LEWIS COUNTY
 PIN 7754.24

TOWN OF WATSON



LEWIS COUNTY
 HIGHWAY DEPARTMENT



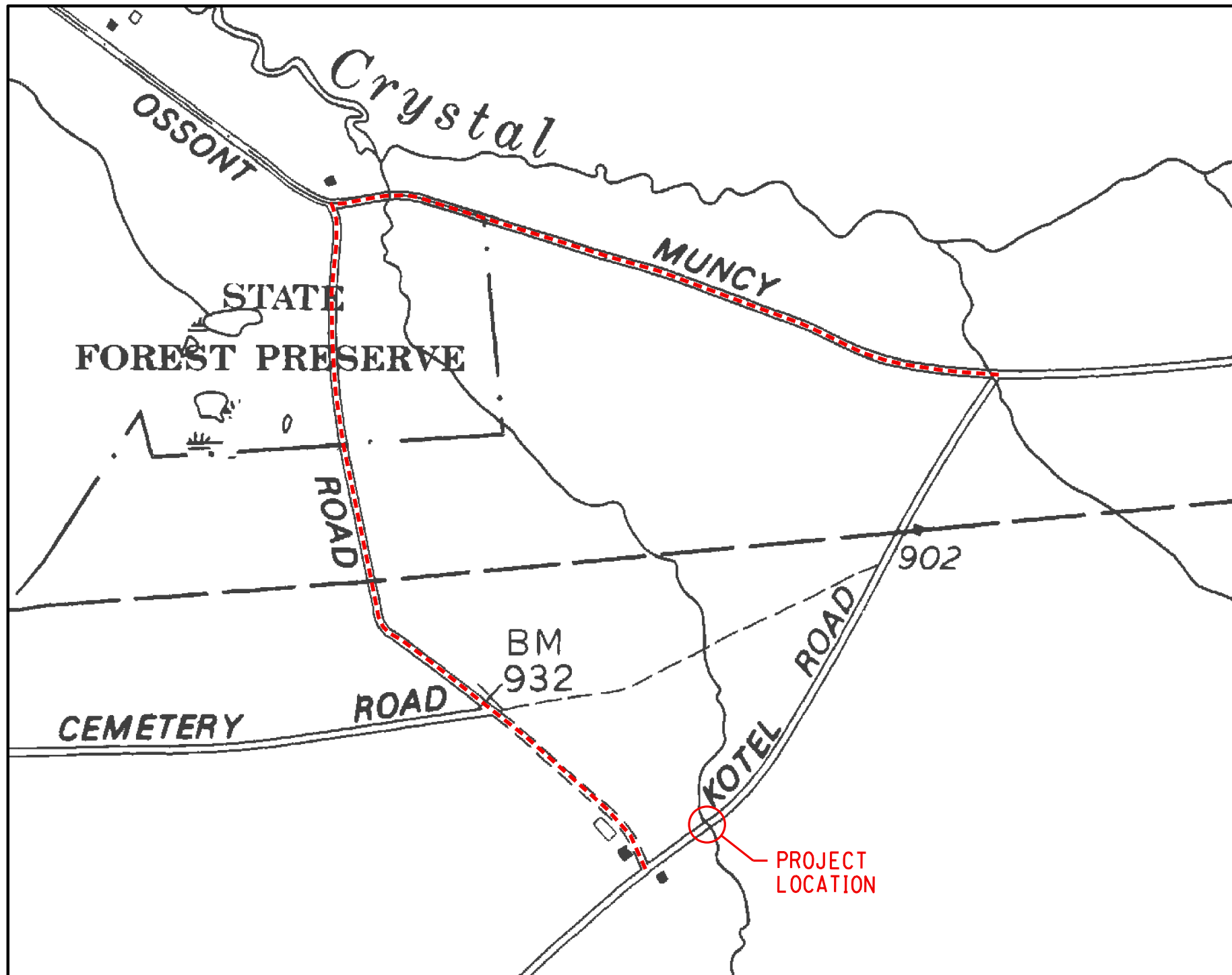

DETOUR ROUTE

REPLACEMENT OF KOTEL ROAD CULVERT
 OVER SOUTH BRANCH CRYSTAL CREEK
 TOWN OF WATSON, LEWIS COUNTY
 PIN 7754.24

LEGEND:
 - - - - - DETOUR ROUTE

TOWN OF WATSON



LEWIS COUNTY
 HIGHWAY DEPARTMENT

